

Capt. Curt's

Trawlers & Yachts LLC



<http://yachtworld.com/rpkays>

6807 Brookhaven Place
Bradenton, FL 34203, USA

Tel 941-730-0715

Fax 941-739-6556

Email captcurtstrawlers@verizon.net

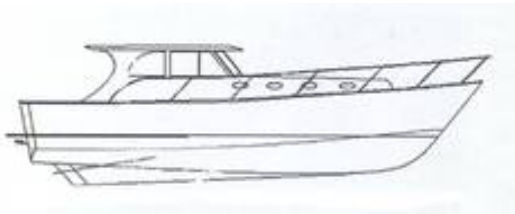

46' Mariner Blue Sea Express World Cruiser

- Year: 2006
- **Current Price: US\$ 429,000** (12/05)
- Located in Factory,
- Hull Material: Fiberglass
- Engine/Fuel Type: Single Diesel
- YW# 12784-1305871

BASE PRICE: \$429,000 - Standard Single 280hp Diesel Engine. Does not include optional equipment, freight, bottom paint or dealer prep.

NEW MODEL for 2006!

Additional information, specifications and pictures coming soon. CALL CAPT. CURT MARSH FOR MORE DETAILS.

Additional Specs, Equipment and Information:

Builder/Designer

Builder: Mariner

Dimensions

LOA: 46'5"

LWL: 40'9"

Beam: 15'

Displacement: 42,000 lbs. Draft: 4'

Tankage

Fuel: 600 gals.

Water: 300 gals.

Construction

Base Price: \$459,000 - Standard Single 270hp Diesel Engine. Optional Larger Engines

Available. This price does not include optional equipment, freight, bottom paint or dealers prep. CALL CAPT. CURT MARSH FOR MORE DETAILS. Hand Laid-up molded fiberglass hull, deck & deck house. FRP Swim platform, Non-skid Fiberglass decks. We can change interior layout plans and options are endless. CALL CAPT. CURT MARSH FOR MORE DETAILS. LISTED BELOW IS THE STANDARD EQUIPMENT LIST.

Galley

Galley Standard Equipment.

- Microwave oven.
- Three burner electric cook top range.
- Norcold or equivalent AC/DC refrigerator with freezer.
- Sink with designer faucet.
- Pressurized water system with marine water heater.
- Stainless steel 300 gallon water tanks.
- Cabinet storage.
- Formica counter tops.

Navigation and Electronics

We customize pilothouse and flybridge to each captains choice. Standard Equipment.

- Two station Sea Star hydraulic steering.
- Two station Morse engine & transmission controls.
- Two instrument control centers.
- Flybridge stainless steel wheel and custom wheel lower helm.

Engine Room & Mechanical

Standard Equipment.

- Standard engine: 270hp diesel.
- Engine option(s) available.
- Freshwater engine cooling
- Fuel lines U.S Coast Guard approved flexible hose.
- Racor fuel filter.
- Engine Alarm System.
- Fabricated steel engine mount saddles.
- Four molded FRP 150 gallon fuel tanks.
- Stainless steel rudders.
- 7-KW or greater diesel Genset.
- Manual bilge pump.
- Bronze sea strainer.
- Seacocks on underwater thru-hull fittings.

Electrical System

Standard Equipment.

- Marincor shore power inlet with 50-amp rating.
- Main circuit breaker panel with volt & ammeters for 12-v DC and 120-v AC.
- Color-coded wiring harness.
- 12v electrical outlets in saloon & bridge.
- 12-v electric lights: 8-main salon with switch next to aft door, 2-forward cabin, under berth lighting, 1-head, 1-shower, 6-engine room, 1-aft deck, 2-lazarette.
- GFCI protection.
- Six heavy duty 12-v batteries with selector switch.
- Battery charger.
- Two electric bilge pumps with automatic float

- 110-volt electrical outlets.
- switches.
- Automatic 12 volt shower sump pumps.
- Bonding systems with zinc anode.

Deck and Hull Equipment

Standard Equipment.

- Anchor locker.
- Stainless steel bow rail.
- Type 316 stainless steel deck hardware.
- Vinyl upholstery on pilothouse seats.
- Bridge seating with storage underneath.
- Fabric covered berth mattresses.
- Carpets, except in galley & pilothouse where cabin sole is teak & holly.
- Interior teak varnished with satin finish.
- Companionway door.
- Port and starboard bulwark doors.
- Cockpit storage.
- FITTINGS:
 - Southco door hardware.
 - Manship 24-inch x 24-inch stainless steel hatches.
 - Manship stainless steel port holes.
- Compass.
- Electric air horn.
- Three 12-volt pantograph windshield wipers.
- International navigation lights.
- Cockpit and bridge deck courtesy lights.
- FRP non-skid decks.
- FRP swim platform.
- Hardtop hatch & forward cabin hatches.
- Opening screened ports in staterooms & washrooms.
- Aluminum frame windows in pilothouse & salon.
- Solid laminate hull with vinylester resins in external layers and fitted with internal FRP grid.
- Aluminum cabin sole beams.
- Watertight engine room bulkheads.
- Engine room insulation.
- HEAD:
 - Electric toilets in master and guest heads.
 - Two 30-gallon head holding tanks with both deck pump-out & gravity drain.
 - Separate shower stall.
 - Shower sump pump.
 - Built-in vanity.
 - Mirror.

Disclaimer

The Company offers the details of this vessel in good faith but cannot guarantee or warrant the accuracy of this information nor warrant the condition of the vessel. A buyer should instruct his agents, or his surveyors, to investigate such details as the buyer desires validated. This vessel is offered subject to prior sale, price change, or withdrawal without notice.

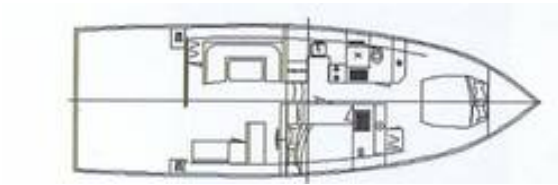

Inside Floor Plan

